

SISMOJOINT®

EARTHQUAKE-RESISTANT EXPANSION JOINT

EXTRACTABLE FORMWORK FOR EXPANSION JOINT IN AKYLUX PANEL TO INSERT BETWEEN THE BOTH SHUTTERS, BEFORE THE SECOND POURING

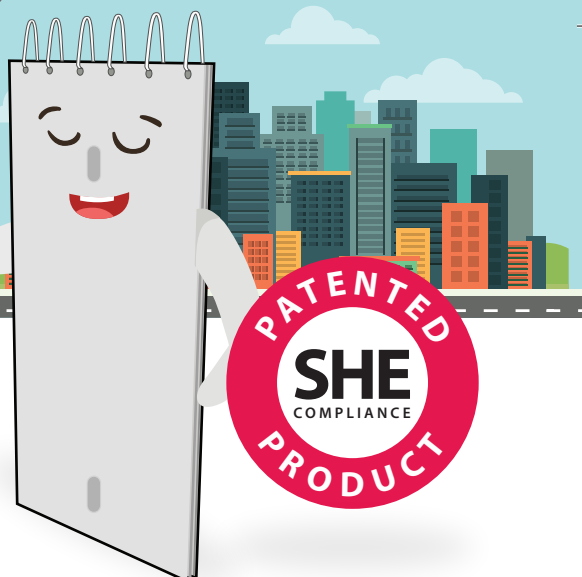

TECHNICAL CHARACTERISTICS & BENEFITS

- Standard / Customised dimensions
- Its extraction allows the achievement of a regular earthquake-resistant expansion joint, without any impurity, in accordance with the EUROCODE 8
- Re-usable more or less 10 times
- Holes for the rods crossing
- Weatherproof
- Concrete's pressure resistant
- The Polypropylene's flexibility allows an easy extraction
- Height : up to 4.70m
- Oblong holes allowing the height adjustment on 70mm

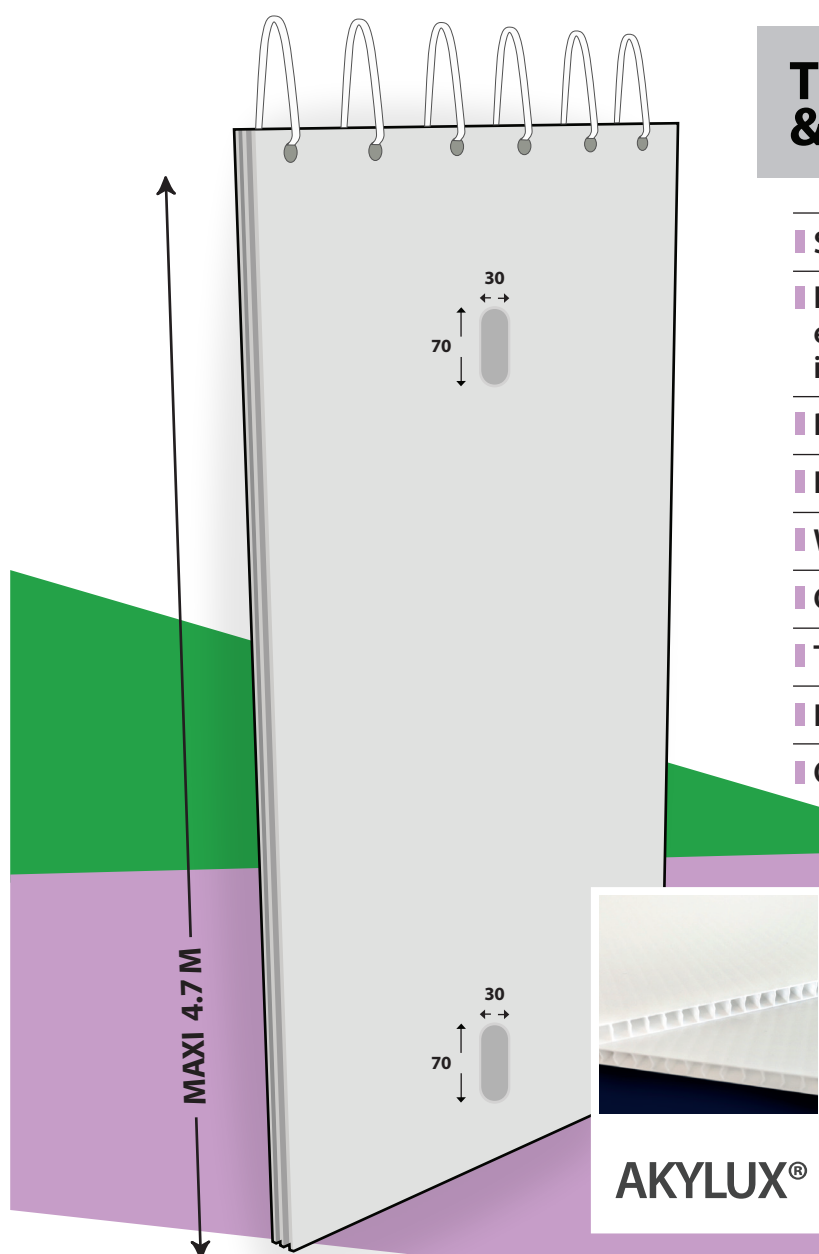

STANDARD DIMENSION

HUSSOR® shutter

thickness : 20mm
width : 1.20m
height : 3.00m

HUSSOR® shutter

thickness : 40mm
width : 1.20m
height : 3.00m

HUSSOR® shutter

thickness : 60mm
width : 1.20m
height : 3.00m

OUTINORD® shutter

thickness : 20mm
width : 1.25m
height : 3.00m

OUTINORD® shutter

thickness : 40mm
width : 1.25m
height : 3.00m

OUTINORD® shutter

thickness : 60mm
width : 1.25m
height : 3.00m

Specials dimensions on demand

- The implementation of the slipcover (on the second shutter's side) make the demoulding easier
- Process which allows a safe extraction without any previous shutter handling

UNE QUESTION ?
04 73 78 57 41

siib France
Groupe MABAMURE

SISMOJOINT

EARTHQUAKE-RESISTANT EXPANSION JOINT

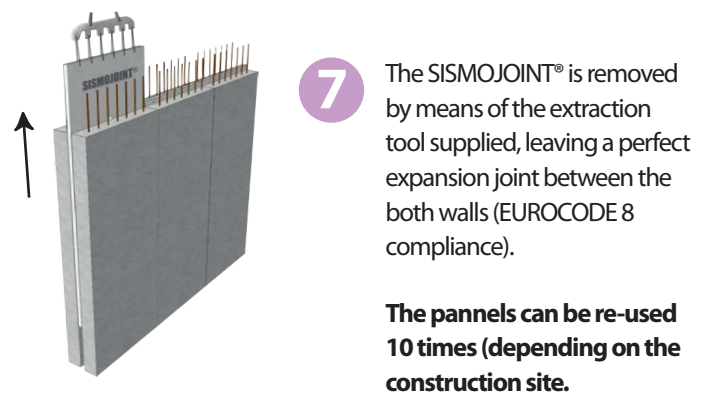
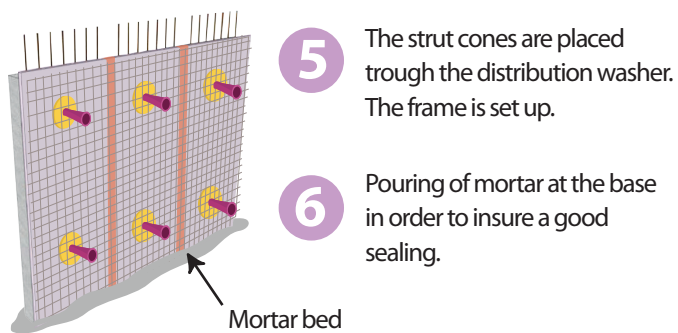
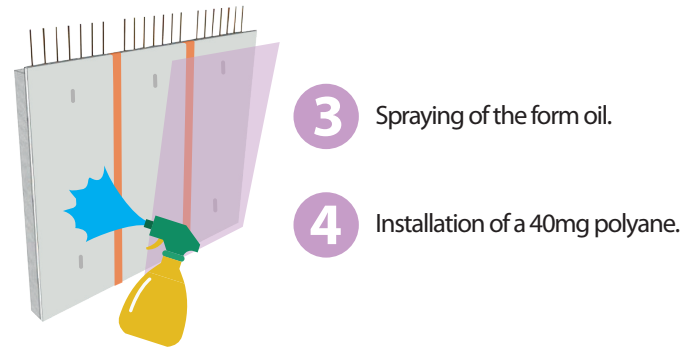
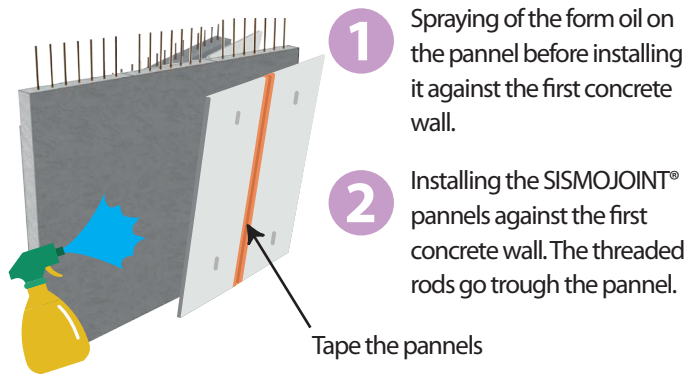

■ The SISMOJOINT® can be removed with an extraction strenght between 600 & 1800 kg



ENVIRONMENTAL PROTECTION

100% recyclable Polypropylene
Incinerable without toxic fumes
Burns out without leaving residues